

BYT G4N FLAT G4N

| | |
|--------------------------------|----------------------|
| 1. VSTUPNÁ PREDISŇ / LOBBY | 5,46 m ² |
| 2. OBÝVACIA IZBA / LIVING ROOM | 19,50 m ² |
| 3. IZBA / ROOM | 11,45 m ² |
| 4. IZBA / ROOM | 12,85 m ² |
| 5. KÚPEĽŇA / BATHROOM | 5,08 m ² |
| 6. WC / TOILET | 1,71 m ² |
| 7. CHODBA / CORRIDOR | 4,59 m ² |
| 8. KUCHYŇA / KITCHEN | 13,08 m ² |

CELKOVÁ PLOCHA / TOTAL AREA 73,72 m²

9. Balkón / balcony 6,86 m²

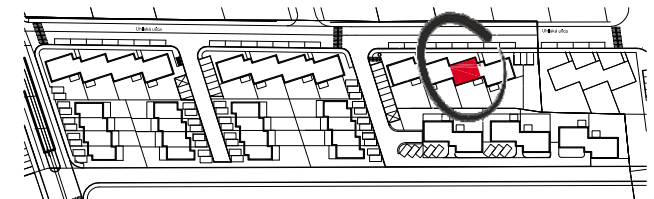

situácia objekt G / situation building G
schéma pôdorysu 2. podlažia / scheme of second floor

